



QR Code of New Saket Phase - 2

UPRERA Website: www.up-rera.in

Promoter Name: Inprosper Infrastructure LLP (UPRERAPRM2190)

| | | |
|-------------------|-----------------|--------------------------------|
| New Saket | UPRERAPRJ2459 | Land Area 12,035 Square Metres |
| New Saket Phase-2 | UPRERAPRJ791876 | Land Area 23,889 Square Metres |



NEWSAKET

M E E R U T

A RESIDENTIAL TOWNSHIP

A
Blissful Life
is Waiting for you

2 & 3 BHK APARTMENTS, SHOPS & OFFICES



LOW
RISE
LIVING

Make Your Wishes A Reality



After the Immense Success of the First Phase,

Welcome to PHASE TWO

Which is situated 5 km away from Saket, a posh area of Meerut, close to the national capital Delhi. New Saket is the first of its kind affordable housing project in the heart of Meerut available in a pocket-friendly range with a perfect blend of man-made structure and natural beauty.

With Landcraft Group's years of quality, trust and track record of numerous successful projects and Bansal Realty's trust, respect and renowned historical pedigree in the entire Meerut region and beyond, New Saket is best suited for residential and commercial outlets. Additionally, home buyers will be able to enjoy several financial and other benefits offered by the state and central governments.

The New Saket is beautifully designed and the residents will enjoy quality living in a lush environment with abundant greenery and plantations.



Site Plan



- TYPE - 01**
2BHK+STORE+2 TOILETS
CARPET AREA : 52.67 Square Metre (566.9 sq.ft.)
TOTAL AREA : 91.97 Square Metre (990 sq.ft.)
- TYPE - 02**
2BHK+2 TOILETS
CARPET AREA : 45.26 Square Metre (487.2 sq.ft.)
TOTAL AREA : 78.87 Square Metre (849 sq.ft.)
- TYPE - 03**
1BHK+STORE+1 TOILET
CARPET AREA : 38.08 Square Metre (409.9 sq.ft.)
TOTAL AREA : 63.45 Square Metre (683 sq.ft.)
- TYPE - 04**
3BHK+2 TOILETS
CARPET AREA : 59.27 Square Metre (637.98 sq.ft.)
TOTAL AREA : 108.97 Square Metre (1173 sq.ft.)
- TYPE - 05**
2BHK+STORE+2 TOILETS
CARPET AREA : 47.61 Square Metre (512.47 sq.ft.)
TOTAL AREA : 88.26 Square Metre (950 sq.ft.)
- TYPE - 06**
2BHK+2 TOILETS
CARPET AREA : 45.83 Square Metre (493.31 sq.ft.)
TOTAL AREA : 84.26 Square Metre (907 sq.ft.)
- TYPE - 07**
2BHK+1 TOILET
CARPET AREA : 42.56 Square Metre (458.12 sq.ft.)
TOTAL AREA : 73.67 Square Metre (793 sq.ft.)
- COMMERCIAL**
- SCHOOL**

Floor Plan

TYPE 4

3 BHK + 2 TOILETS

Carpet Area : 59.27 Square Metre (637.98 Sq.ft.)

Total Area : 108.97 Square Metre (1173 Sq.ft.)



↑
ENTRY

Floor Plan

TYPE 5

2 BHK + STORE + 2 TOILETS

Carpet Area : 47.61 Square Metre (512.47 Sq.ft.)

Total Area : 88.26 Square Metre (950 Sq.ft.)

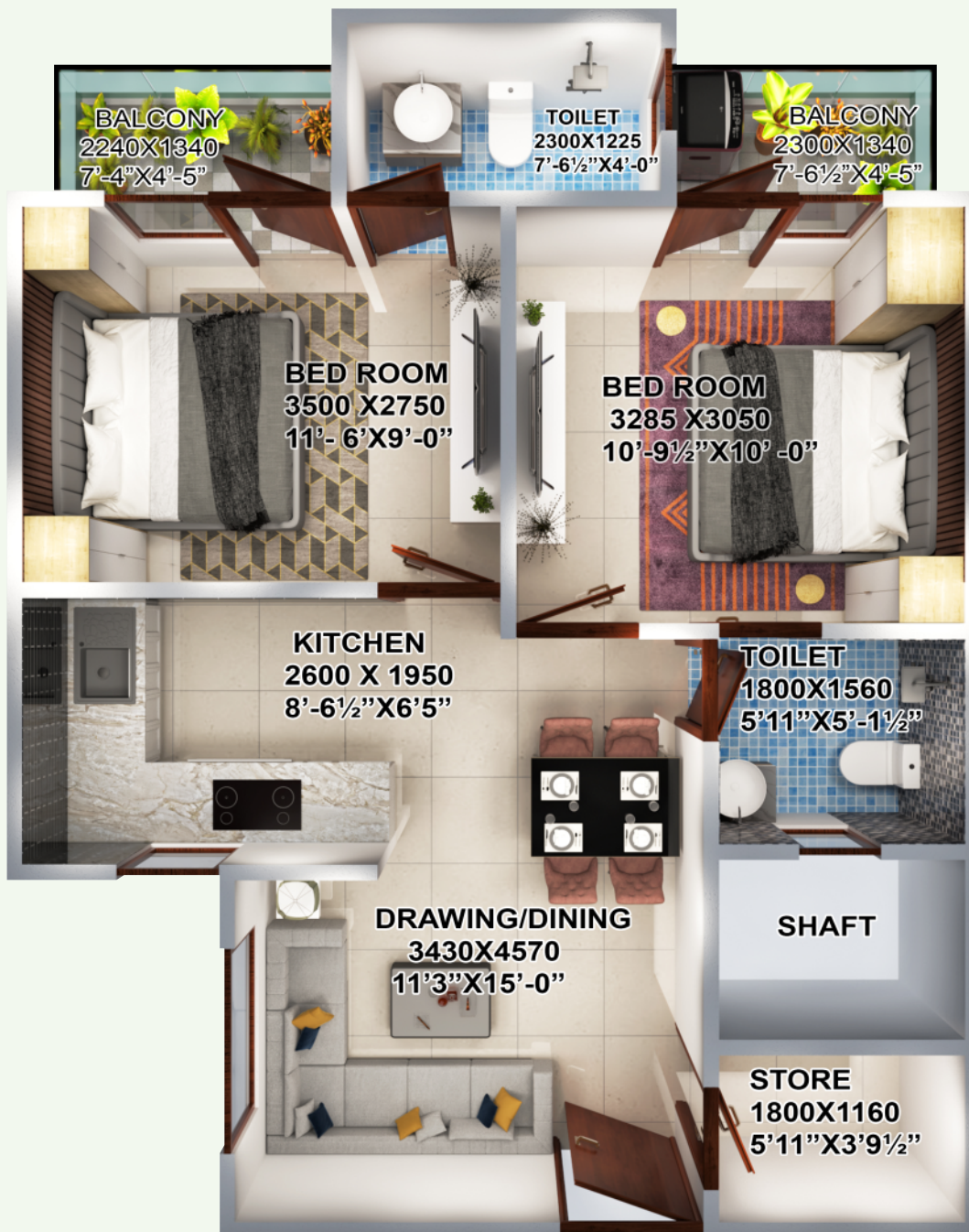

↑
ENTRY

Floor Plan

TYPE 6

2 BHK + 2 TOILETS

Carpet Area : 45.83 Square Metre (493.31 Sq.ft.)

Total Area : 84.26 Square Metre (907 Sq.ft.)



Floor Plan

TYPE 7

2 BHK + 1 TOILET

Carpet Area : 42.56 Square Metre (458.12 Sq.ft.)

Total Area : 73.67 Square Metre (793 Sq.ft.)



Easy to Connect

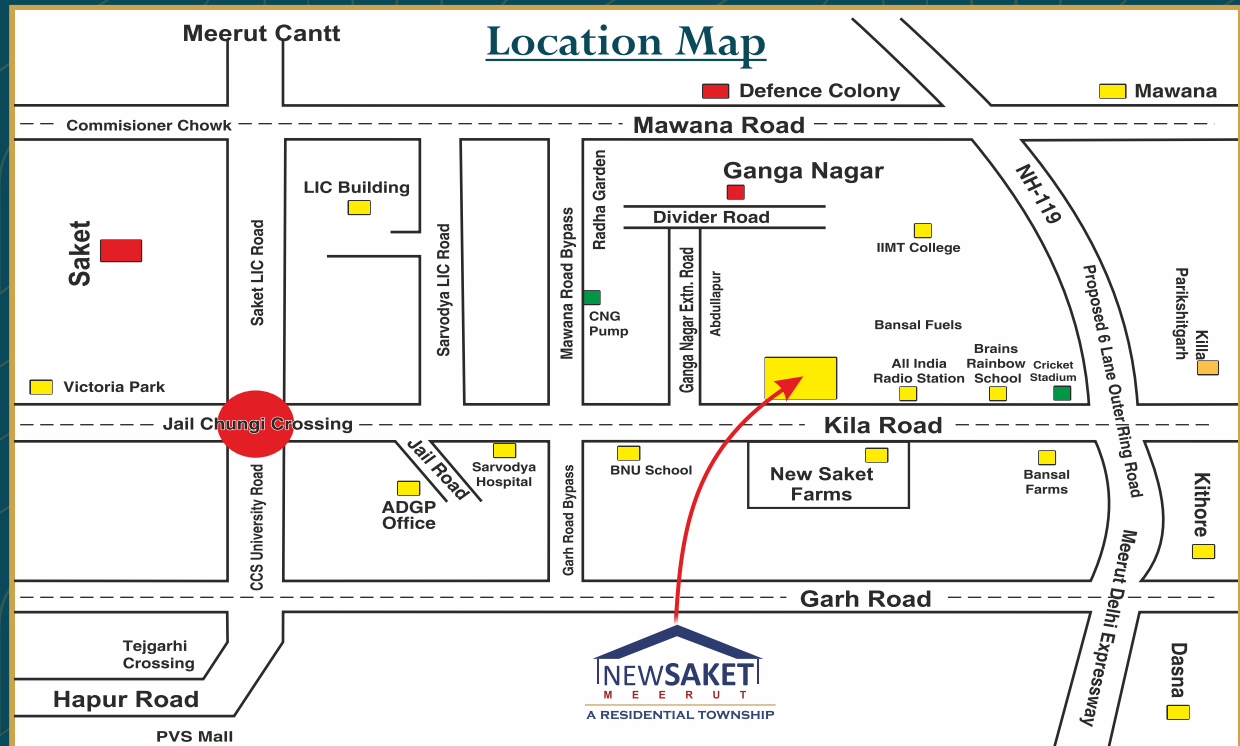

Finance Available:



New Saket Phase - 2 Collection Account - Inprosper Infrastructure LLP
Collection Account for New Saket Phase 2 -

Account No. 120024106961, Canara Bank Ltd., Branch - Abu Lane Meerut, IFSC - CNRB0000199

Site Office : New Saket, Kila Road, Near Aakashvani Kendra, Meerut, U.P.

Email : info@newsaket.com

Website : www.newsaket.com

Call: 8010542542

All specifications, designs, layout, images, conditions are only indicative and some of these can be changed at the discretion of the builder/architect/authority. These are purely conceptual and constitute no legal offerings.

Map not to scale & All Timings are Approximate.